

## List of Trees in the Tree Tour in Spital Cemetery

1.	Small-leaved Lime	<i>Tilia cordata</i>
2.	Lombardy Poplar	<i>Populus nigra</i> var. 'Italica'
3.	Mountain Ash	<i>Sorbus aucuparia</i>
4.	Turkey Oak	<i>Quercus cerris</i>
5.	Snowy Mesphilus	<i>Amelanchier lamarchii</i>
6.	Silver Birch	<i>Betula pendula</i>
7.	Common Osier or Basket Willow	<i>Salix viminalis</i>
8.	European Larch	<i>Larix decidua</i>
9.	Willow Leaf Pear	<i>Pyrus salicifolia pendula</i>
10.	Copper Beech	<i>Fagus sylvatica purpurea</i>
11.	English Elm	<i>Ulmus minor</i> 'Atinia'
12.	Bird Cherry	<i>Prunus padus</i>
13.	Holly	<i>Ilex aquifolium</i>
14.	Elder	<i>Sambucus</i>
15.	Variegated Sycamore	<i>Acer pseudoplatanus</i> f. variegatum 'Simon-louis Frères'
16.	Lawson Cypress	<i>Chamaecyparis lawsoniana</i>
17.	Scots Pine	<i>Pinus sylvestris</i> also Austrian Pine <i>Pinus nigra</i>
18.	English Oak	<i>Quercus robur</i>
19.	English or European Yew	<i>Taxus baccata</i>
20.	European Ash	<i>Fraxinus excelsior</i>
21.	Common Hornbeam	<i>Carpinus betulus</i>

Some notes:

Please enjoy directing yourself on this tour using the accompanying map.

— . — . — paths are part of the old path layout and in some cases grown/buried over.

— — — double broken lines are paths that have been surfaced but some have steps and are uneven so please take care. The cemetery is on a steep hillside.

Parking is available on Spital Lane, Cemetery Road and along Lime Tree Avenue just inside the top entrance.

The nearest public toilets are at Chesterfield Railway Station.

Dogs are welcome but please keep on a lead and use the dog poo bins which are situated at both the top and bottom entrances.

The cemetery is just a 10 minute walk from the centre of Chesterfield.

# A Tree Tour in Spital Cemetery

Spital Cemetery  
Hady Hill  
Chesterfield  
S41 0DZ

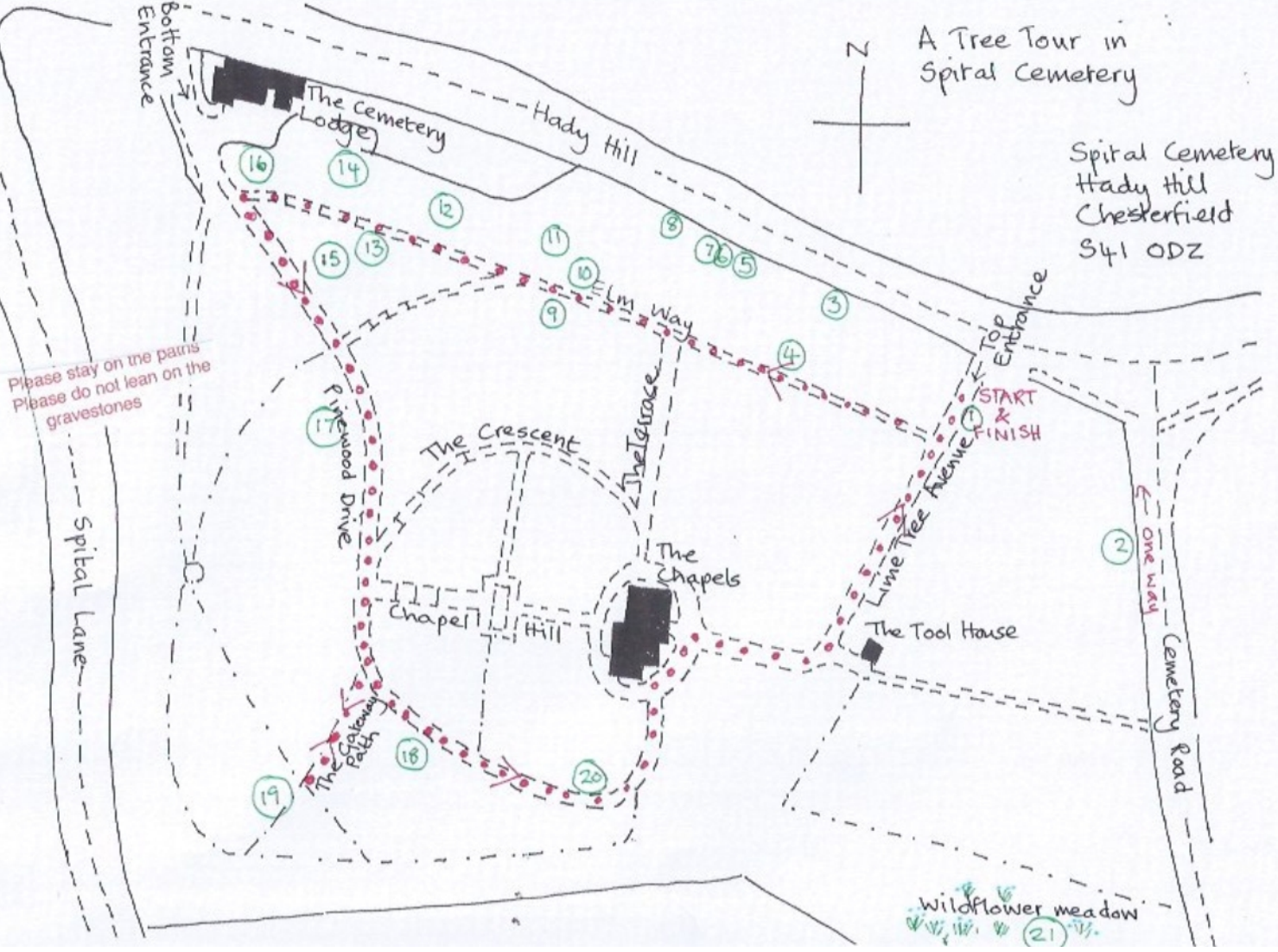
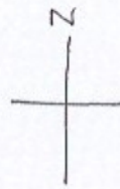

Please stay on the paths  
Please do not lean on the gravestones

Wildflower meadow  
(21)